

Wear protective clothing when operating the sink.

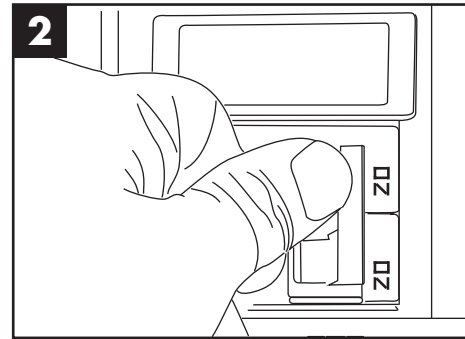

Turn the main breaker or power disconnect switch ON.

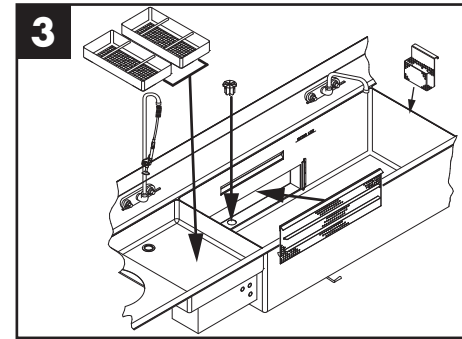

Install the screens and baskets.

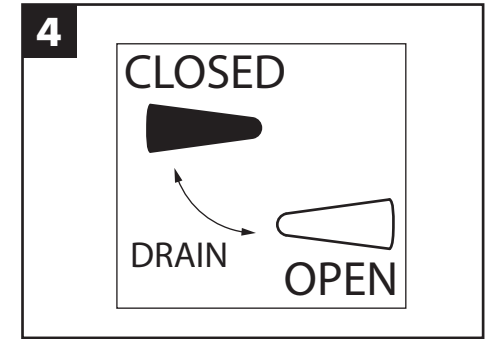

Turn the drain handles to the 9 o'clock position to close.

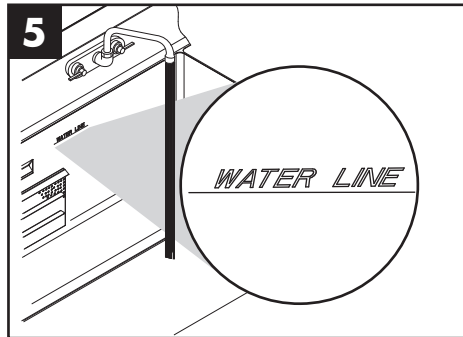

Fill wash tank to the Water Line mark. Fill the remaining tanks. Add chemicals per the supplier's instructions.

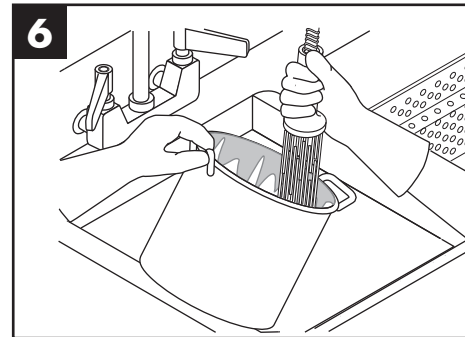

Prescrape wares in the scrapper to remove large food soils.

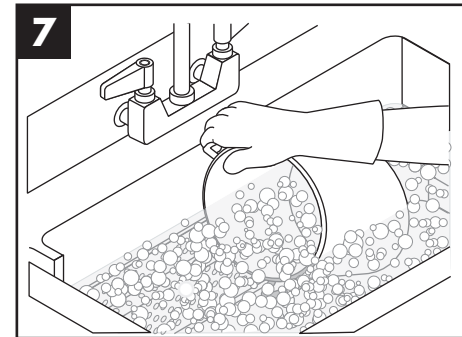

Submerge wares in the wash tank. Do not nest items inside each other.

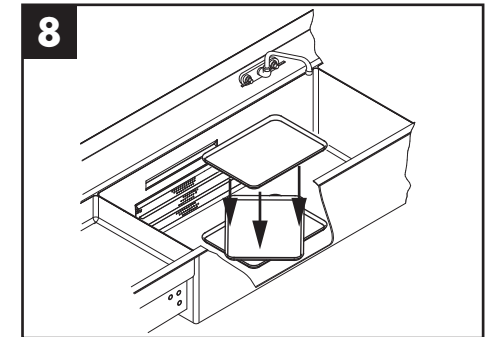

Load baking sheets in a criss-cross pattern or use the optional bake sheet rack.

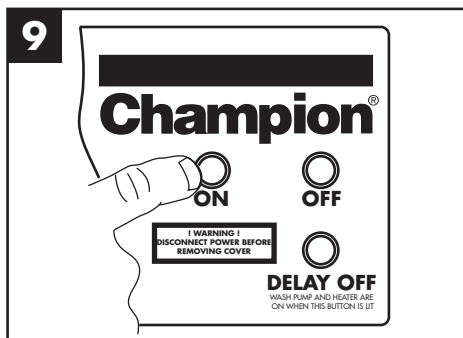

Push the ON push button to start. Push the OFF push button to stop.

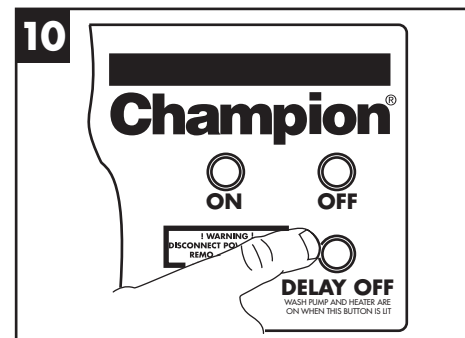

Pushing the DELAY OFF push button when the machine is running will start an automatic four hour cycle.

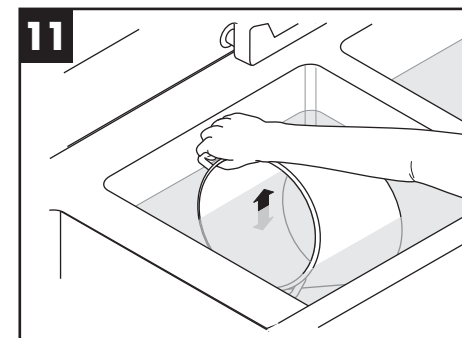

Rinse wares in the rinse tank to remove soap and loose soils.

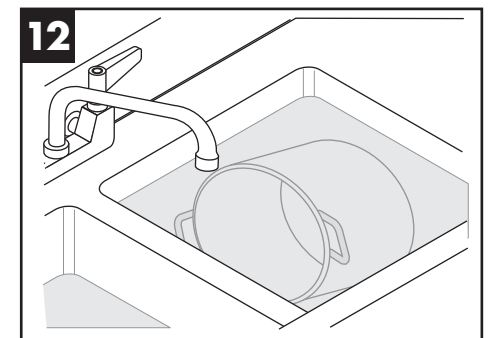

Soak wares in the sanitizer sink according to the chemical supplier's instructions. Remove and dry.

*After each shift and at the end of the day*



1 Push the OFF push button to stop. Remove any wares from the sink.

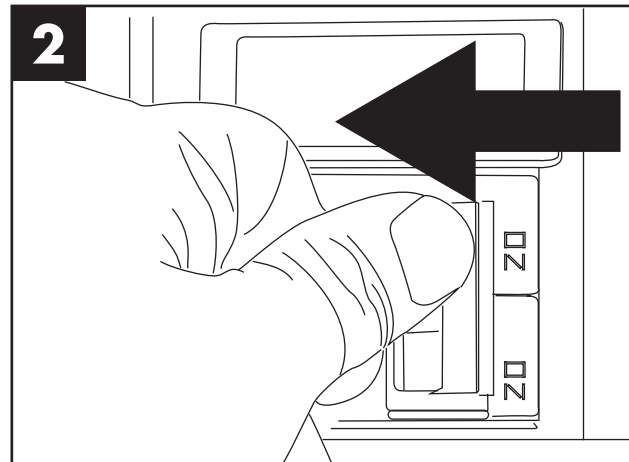

2 Turn the main breaker or power disconnect switch OFF.

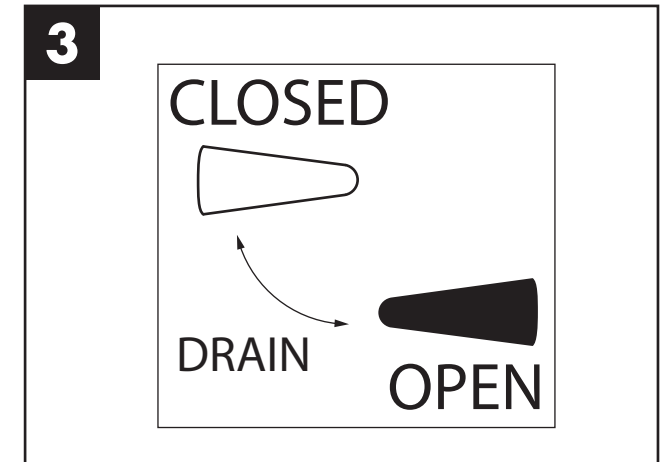

3 Turn the drain handles to the 3 o'clock position to open.

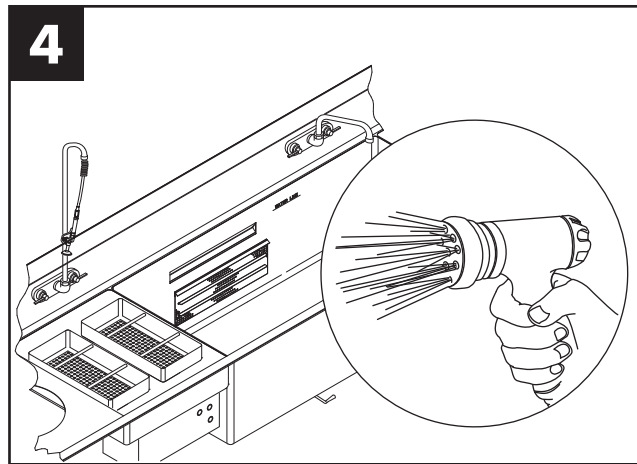

4 Spray the interior of the sink with fresh water.

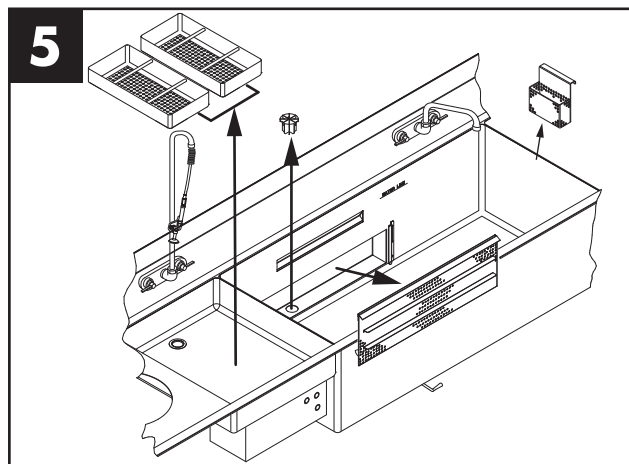

5 Remove the scrap screen, pump suction strainer and utensil basket and flush clean.

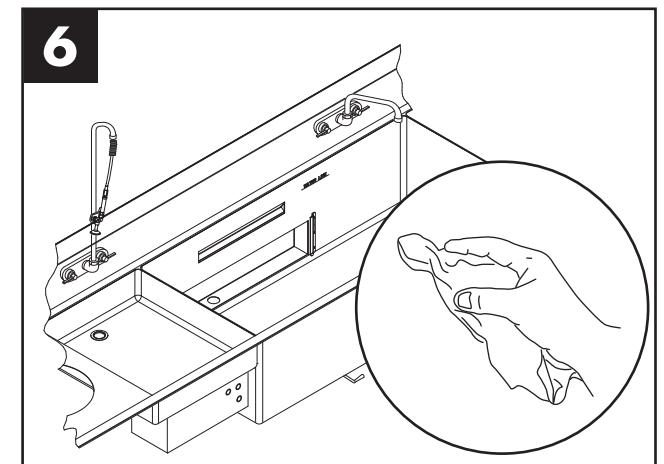

6 Wipe the interior of the sink with a soft cloth and mild detergent.