

Champion[®]

The Dishwashing Machine Specialists

Project _____

Item No. _____

Quantity _____

33BD-PRO

STANDARD FEATURES

- Automatic heat cutoff (when conveyor stops)
- Blower motor, 2-Hp
- Choice of electric or steam heat
- Control circuit, 120-volt, completely interwired with dishwashing machine controls
- Heavy gauge stainless steel frame and cabinet
- Machine vent connection, 7" stack with locking damper
- Thermal overload protection for electrical blower-dryer
- 33" Hood design

33BD-PRO

**Blower-Dryer for Rack Conveyor
Dishwashing Machine**



SPECIFICATIONS

Motor Horsepower	2
Heating	
Electric, (kW)	8
Steam (lbs./hr. required at 10 psi flow pressure)	65



SPECIFIER STATEMENT

Specified unit will be Champion model 33BD-PRO blower-dryer for rack conveyor dishwashing machines. Features include automatic heat cut-off, 2-Hp blower motor.

1 Year parts and labor warranty.

This EBD catalog sheet is designed to be used in conjunction with the Champion Rack Conveyor Series catalog sheets.

Champion Industries, Inc.
3765 Champion Blvd., Winston-Salem, NC 27105
Tel: 336-661-1556 Fax: 336-661-1979

Champion Industries, Inc.
2764 North Service Rd., Jordan Station, Ontario Canada L0R 1S0
Tel: 905-562-4195 Fax: 905-562-4618

championindustries.com

championindustries.com/canada

CH038

(pdf) 11/6/23 Printed in U.S.A.

33BD-PRO Blower Dryer For Rack Machine

Electric

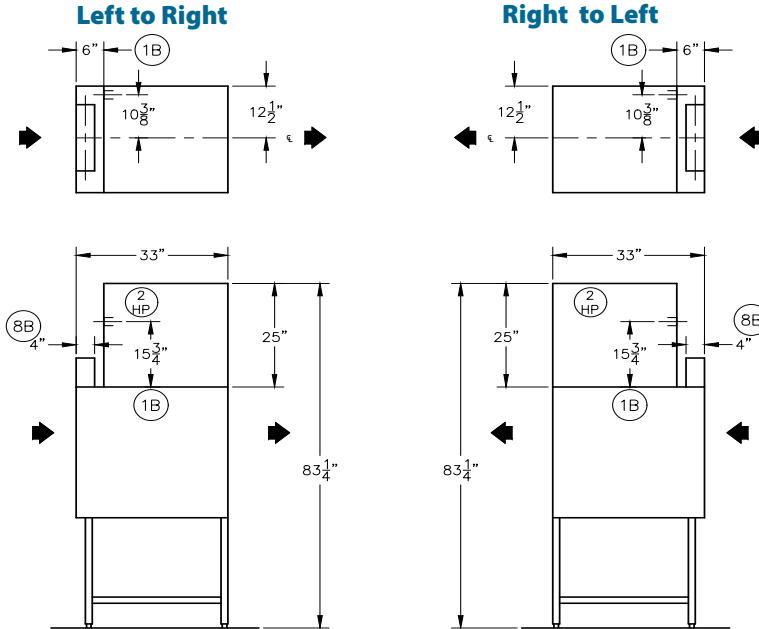

Steam

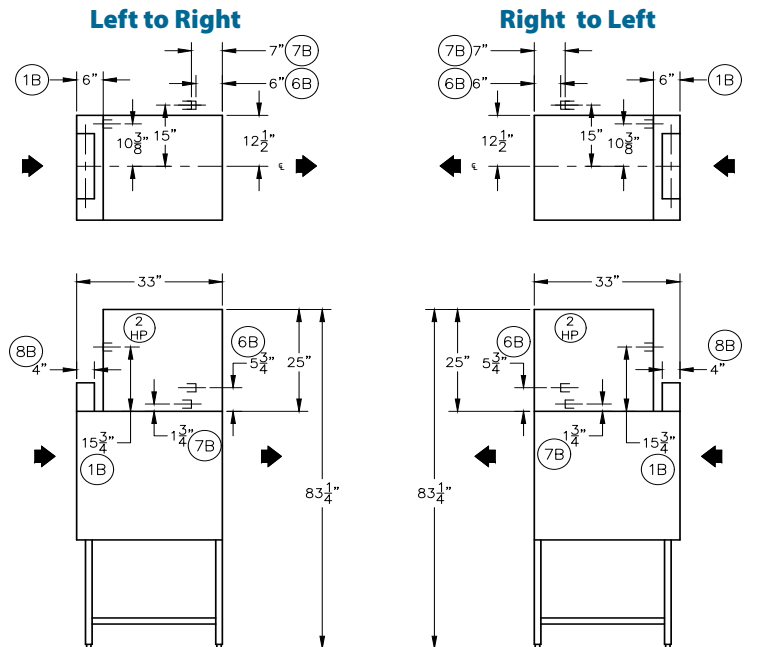

- ①B - Machine main electrical supply (see table below)
- ⑥B - Steam (10-30 PSI) Flow Press
3/4" NPT Blower/Dryer
65 lb/hr. Consumption
- ⑦B - Condensate No Back Pressure
1/2" NPT Blower/Dryer
Return to Boiler

Model 33BD-PRO Electric Heat			
Voltage	Rated Amps	Minimum Supply Circuit Ampacity	Maximum Overcurrent Protective Device
208/60/3	29	40	40
240/60/3	26	35	35
480/60/3	13	20	20
575/60/3	11	15	15

Note: When machine is equipped with blower/dryer system, for normal size dishroom, the dishroom ventilation should be increased by 600 CFM.

Model 33BD-PRO Steam Heat			
Voltage	Rated Amps	Minimum Supply Circuit Ampacity	Maximum Overcurrent Protective Device
208/60/3	7	15	15
240/60/3	6	15	15
480/60/3	3	15	15
575/60/3	3	15	15

Note: When machine is equipped with blower/dryer system, for normal size dishroom, the dishroom ventilation should be increased by 600 CFM.